



The OME100NW is designed to work effectively in picking applications. The open platform gives the operator close access to both load and controls. Good performance together with an ergonomic, reliable design will help users to achieve a high level of productivity.



Technical Details		OME100NW
Power unit		Electr. battery
Operating type		Stand on
Rated capacity	kg	1000
Load centre	mm	600
Weight without battery, max.	kg	1162
Max axle load drive wheel, without/with rated load	kg	1208/639
Max axle load supp.wheel, without/with rated load	kg	884/2459
Support arm wheels, Vulkollan	mm	Ø140x60
Drive wheel, Vulkollan	mm	Ø250x105
Travel speed, without/with rated load	km/h	12.0/7.0
Travel speed, without/with rated load, in fork direction	km/h	10.5/6.0
Lift speed, without/with rated load	m/s	0.14/0.10
Lowering speed, without/with rated load	m/s	0.17/0.17
Gradient, without/with rated load	%	13/6
Service-/parking brake		1 stage electromagnetic brake
Drive motor/Intermittent rating	kW/%	2.5/60
Lift motor/Intermittent rating	kW/%	2.2/5.0
Battery (5h discharge)	V/Ah	24/465—620
Battery weight, min./max.	kg	475/530 <sup>1)</sup>
Steering system		electronic
Speed control		stepless
Steering arc	°	200

Dimensions, mm		OME100NW
x	Back of fork to wheel centre	110
y	Wheel base	1350
h <sub>7</sub>	Instep height	180
h <sub>13</sub>	Height of lowered fork	80
h <sub>1</sub>	Height of mast, min.	2450
h <sub>3</sub>	Lft movement	1620
h <sub>4</sub>	Height of mast, max.	4070
h <sub>12</sub>	Platform height	1800
h <sub>23</sub>	Total lift height	1700
l <sub>2</sub>	Truck length incl. back of fork	1648
l <sub>21</sub>	Load frame length std, inside	820/1020/1220
b <sub>1</sub>	Chassis width	810
b <sub>2</sub>	Cab width	780/1000/1200/1400
b <sub>21</sub>	Load frame width std, inside	890/1090/1290
s	Fork thickness	62
e	Fork width	115
l	Fork length	800/1000/1150
b <sub>5</sub>	Width across fork	560/685/776
m <sub>2</sub>	Floor clearance mid wheelbase	55
W <sub>a</sub>	Turning radius	1540
l <sub>9</sub>	Platform length	540
l <sub>24</sub>	Entrance width	480

1) If less than 475 kg, add counterweight up to minimum weight

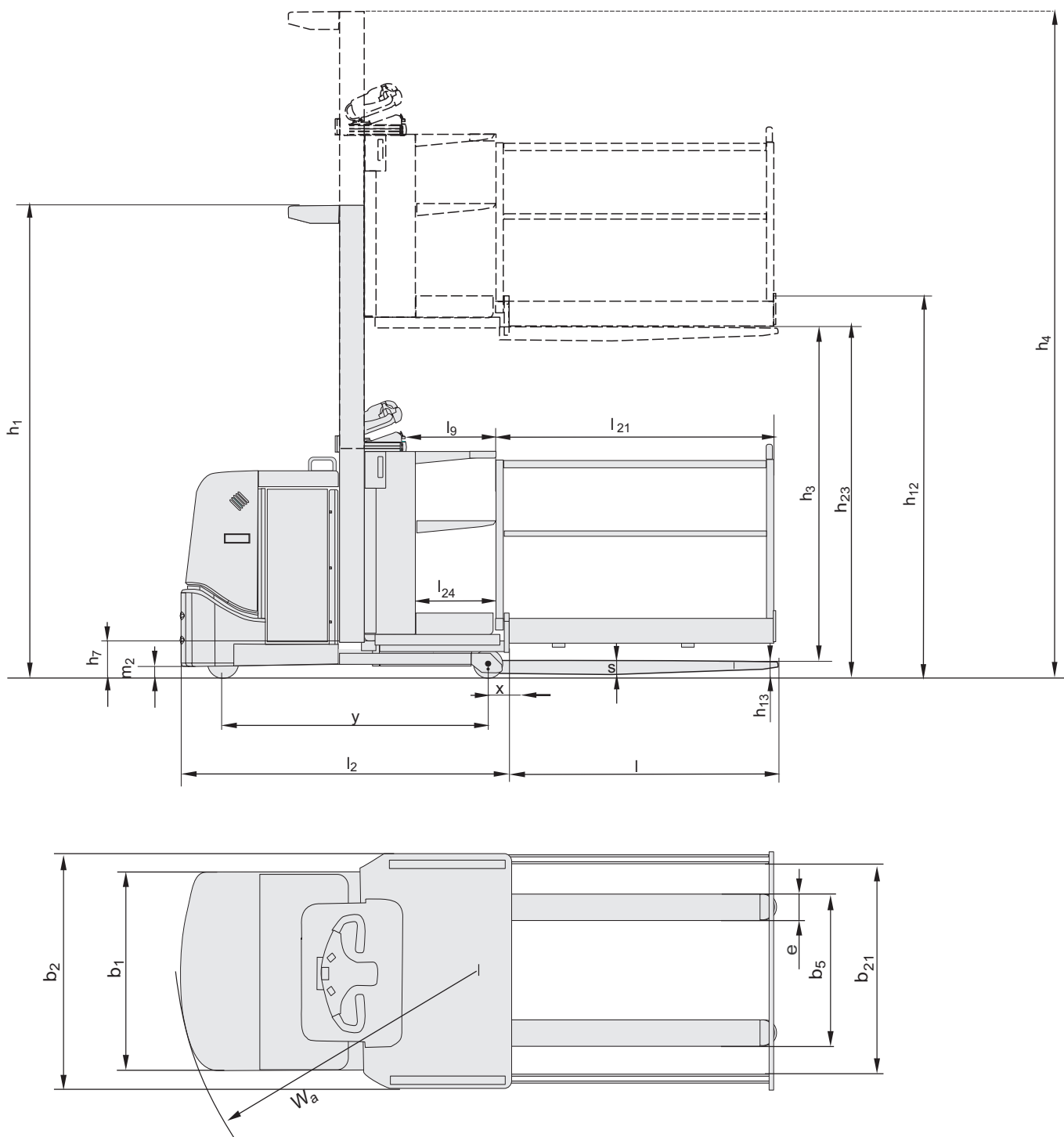

Truck performance and dimensions are nominal and subject to tolerances.  
BT Products AB products and specifications are subject to change without notice.  
All data is based on VDI 2198.



- The new E-man steering concept is ideally suitable for picking activities. Electrical servo steering and easy to use push buttons increase efficiency and are more ergonomic for the operator.
- The BT Powerdrive system provides reliability and simplicity. Can-bus technology means fewer parts and reliable transmission of data. A Pin code start up procedure offers higher operational safety by stopping unauthorised driving.
- The platform has a walk through design. As a result, OME100NW can easily be used for picking of bulky articles. Lifting the operator is done fast and safely, even while driving. The lift capacity is 1000kg.
- The performance of the OME100NW is first-rate. A travel speed of 12 km/h together with high acceleration increases the number of pick-ups. With our motor technology it is very easy to adjust top speed, acceleration and speed reduction to meet individual requirements. There are 10 individually adjustable operator programs.



Truck features	OME100NW
BT Powerdrive System	S
Elevating platform	S
High performance models	S
Controls and instrument	
Information display	S
Power/Electronic steering	S
Driving features	
200° steering	S
Automatic deceleration	S
Electronic regenerative brakes	S
Safety features	
2-step lowering system	O
BT Access Control	S
Dead mans grip	S
Driver detection system	S
Folding sideguards	O
Programmable performance	S
Drivers compartment features	
E-bar	O
Low step-in	S
Storage compartments	S
Writing table	O
Maintenance features	
Easy access for maintenance	S
Fault diagnosis facility	S
Battery management features	
Battery change facility	O
Battery status indicator	S

S = Standard feature

O = Optional feature

— = Not available